

## HİDROLİK DİŞLİ MOTORLAR



### RADYAL PİSTONLU MOTORLAR

KODU	İletim Hacmi cm <sup>3</sup>	Çalışma Basıncı Bar	Max. Basınç Bar	Tork Nm/MPa	Devir d/dk
JMDG3-250	254	225	275	38	8~ 630
JMDG3-300	289	225	275	43	6~ 500
JMDG3-350	340	175	225	50	6~ 400
JMDG6-400	397	250	320	59	5~ 630
JMDG6-450	452	250	320	67	5~ 630
JMDG6-500	491	225	275	73	5~ 500
JMDG6-600	594	225	275	88	4~ 500
JMDG11-700	707	250	320	104	4~ 400
JMDG11-800	784	250	320	116	4~ 400
JMDG11-1000	981	200	250	145	3~ 320



### HİDROLİK DİŞLİ MOTORLAR

KODU	İletim Hacmi cm <sup>3</sup>	Çalışma Basıncı Bar	Devir d/dk
20MR 6.3 x 546	6,3	200	650~ 3500
20MR 8.2x 546	8,2	200	650~ 3500
20MR 10 x 546	10	200	650~ 3500
20MR 11 x 546	11	200	650~ 3500
20MR 12 x 546	12	200	650~ 3500
20MR 14 x 546	14	200	650~ 3500
20MR 15 x 546	15	200	650~ 3500
20MR 16 x 546	16	200	650~ 3500
20MR 19 x 546	19	180,	650~ 3500
20MR 22 x 546	22	180	650~ 3500
20MR 25 x 546	25	160	650~ 3500

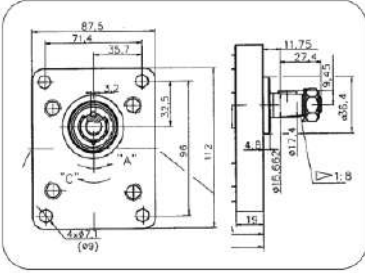

### HİDROLİK DİŞLİ MOTORLAR

KODU	İletim Hacmi cm <sup>3</sup>	Çalışma Basıncı Bar	Devir d/dk
30MR22x568	22	200	500~ 2500
30MR25x568	25	200	500~ 2500
30MR28 x568	28	20	500~ 2500
30MR32 x568	32	200	500~ 2500
30MR36x568	36	200	500~ 2300
30MR42x568	42	200	500~ 2300
30MR46x568	46	200	500~ 2300
30MR50x568	50	200	500~ 2100
30MR55x568	55	200	500~ 1750

